

Self-Adhesive Vapour Control Layer

INFIXTM
VCL



DESCRIPTION OF MATERIAL

- **INFIX™ VCL** is self adhesive protecting material having 5mm x 5mm mesh size, made from the composition of Aluminium Foil, Glass Scrim & LDPE.

TECHNICAL DATA

Properties	Value / Assessment
Backing Material	Aluminium Foil + Glass Scrim + LDPE
Adhesive System	Acrylic Adhesive
Backing Thickness	140 micron
Total Thickness	165 micron
Air Permeability	0%
Tensile Strength kg/50mm	8.4 kg/50mm
Elongation	3.36%
Adhesive to Steel	500 g/cm

APPLICATION

INFIX™ VCL can be used as a jacketing material for

- Piping Insulation of Hot & Cold Fluid
- VRV/VRF Refrigerant Piping Insulation
- HVAC Ducting Insulation
- Process Industry Pipe & Equipment Insulation
- Process Industry Pipe & Equipment Insulation
- Vessel Insulation
- Cold room/cold storage wall (1st layer before insulation can be applied & after insulation to seal the surface & joints)
- Cold room/cold storage floor

FEATURES

- Excellent moisture barrier
- Good radiant heat resistance
- Lightweight
- Easy installation
- Good aesthetics

INFIX™ VCL APPLICATION AREAS:

WALL & FLOOR:

- Moisture gets trapped in wall/floor of any area is due to poor ventilation, low temperature (cold rooms) and rain water ingress, plumbing lines leakages (generally in basement area), etc. This moist surface over wall/floor leads to fungal growth and reduces life of construction.
- **INFIX™ VCL** is self adhesive and can be directly applied to wall and floor surface for moisture control purpose before further application of other layers of insulation material.

1. BASEMENT WALL:

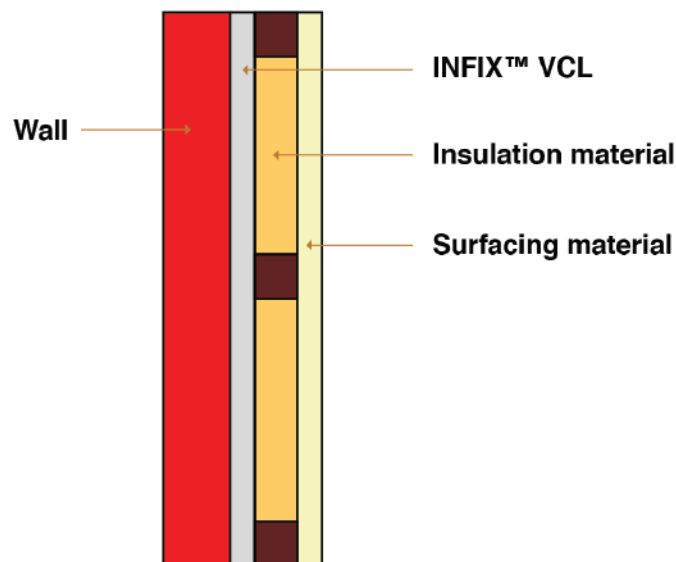

2. BASEMENT/COLD ROOM/COLD STORAGE FLOOR:

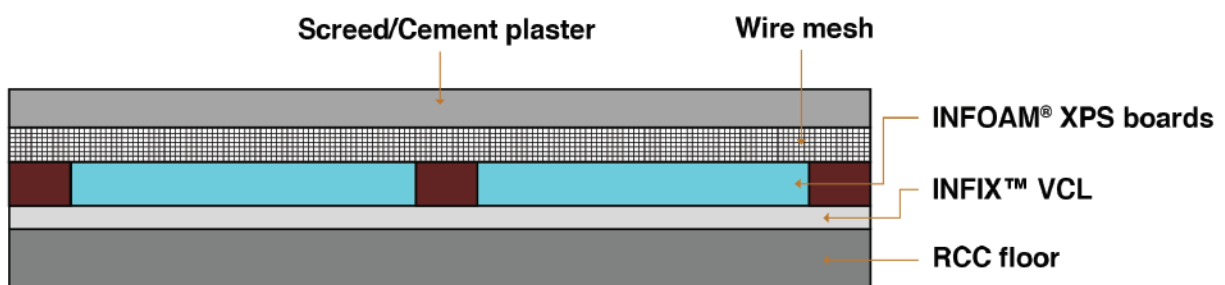

3. COLD ROOM/COLD STORAGE WALL:

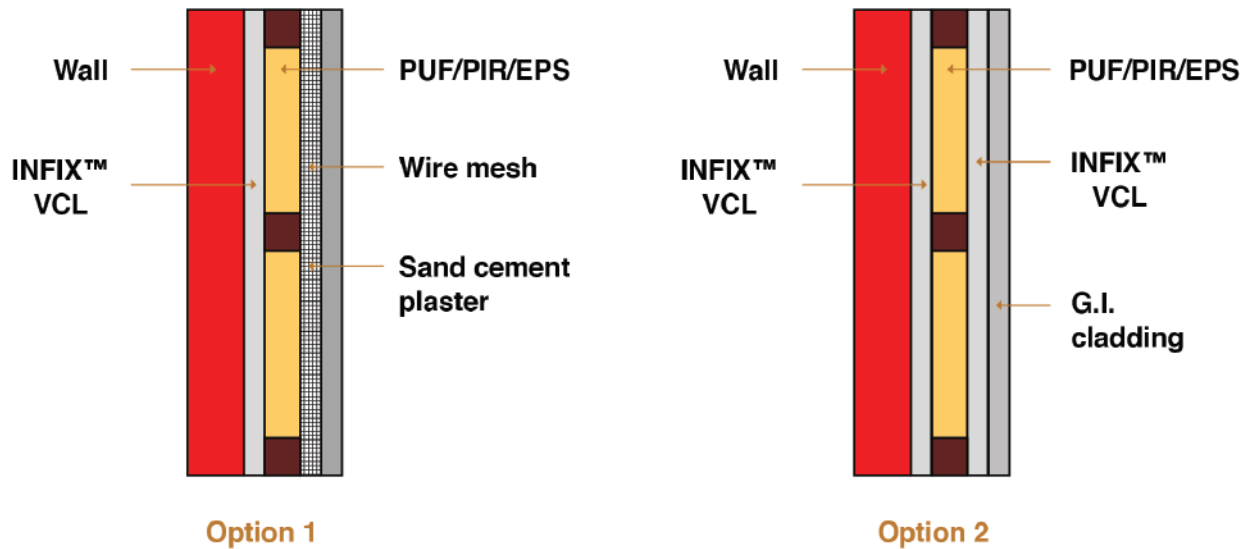

4. HOME THEATRE/STUDIO/CONFERENCE ROOMS/BANQUET HALL WALL:

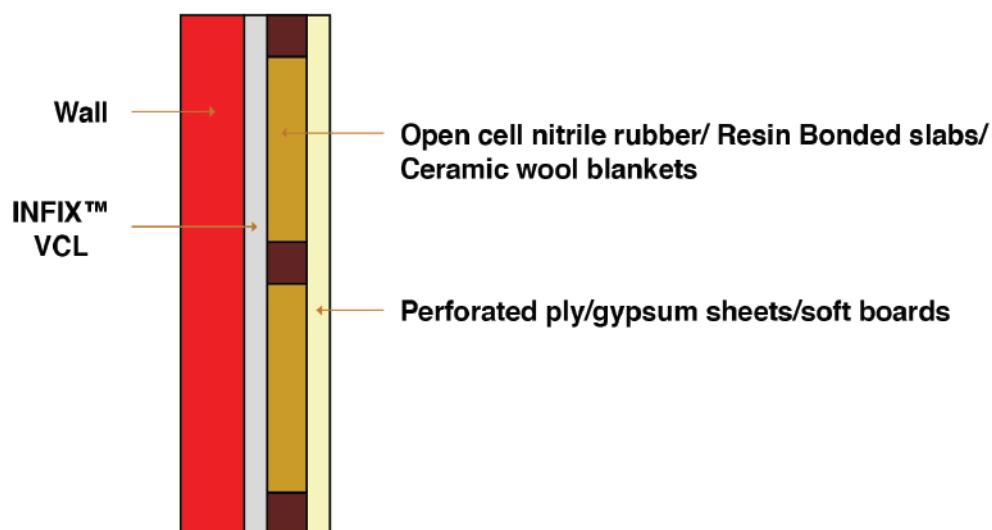

PROTECTIVE LAYER FOR INSULATION MATERIAL:

- **INFIX™ VCL** can be used as a protective layer over insulation material applied over piping/ducting. It will act as a moisture barrier and radiant heat resistant layer.
- **INFIX™ VCL** also provides additional benefit of aesthetics due to its outer look of aluminium foil.

Note: This product is to be used for indoor applications only. It is not suitable for direct exposed applications (Open to sky). It can be used before applying cladding in exposed applications.

1. VRF REFRIGERANT LINES (INDOOR):

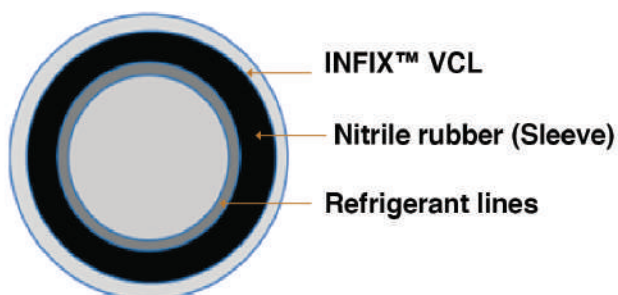

2. VRF REFRIGERANT LINES (OUTDOOR):

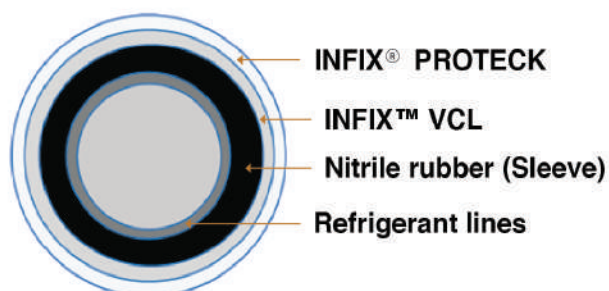

3. CHILLED WATER LINES (INDOOR/OUTDOOR):

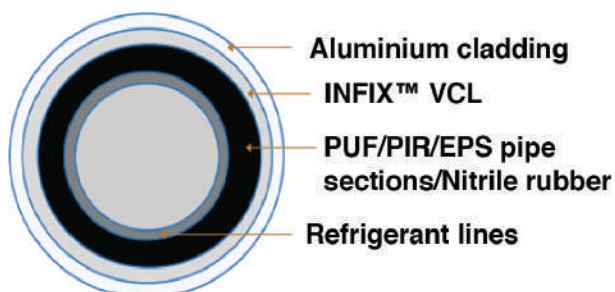

4. BRINE LINES [-5 °C/-10 °C/-20 °C] (INDOOR/OUTDOOR):

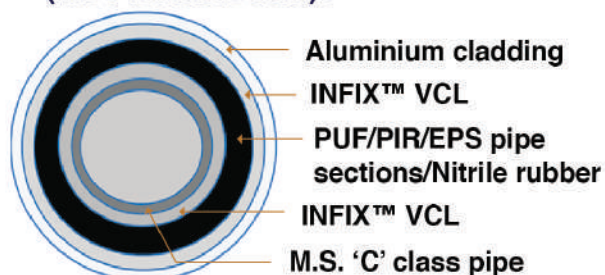

5. HOT WATER LINES (INDOOR/OUTDOOR):

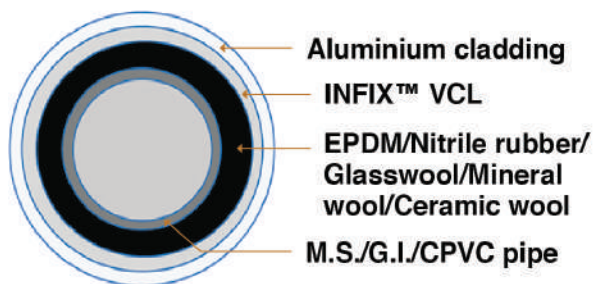

6. HOT WATER LINES (SOLAR PIPES) (INDOOR/OUTDOOR):

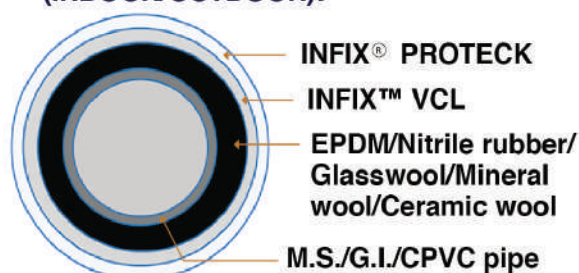

7. SUPPLY/RETURN AIR DUCTS (INDOOR):

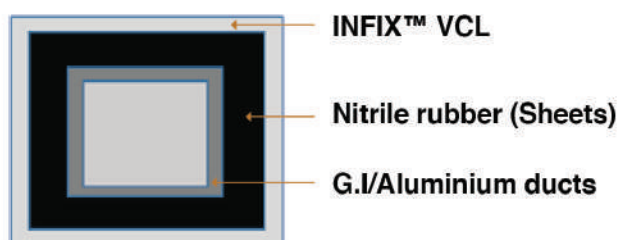

8. SUPPLY/RETURN AIR DUCTS (OUTDOOR):

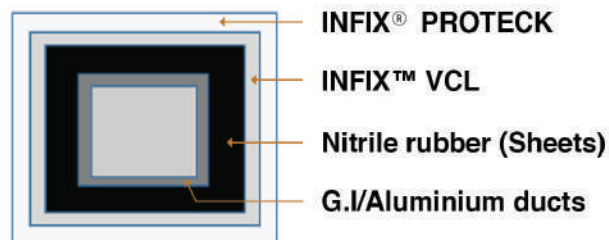

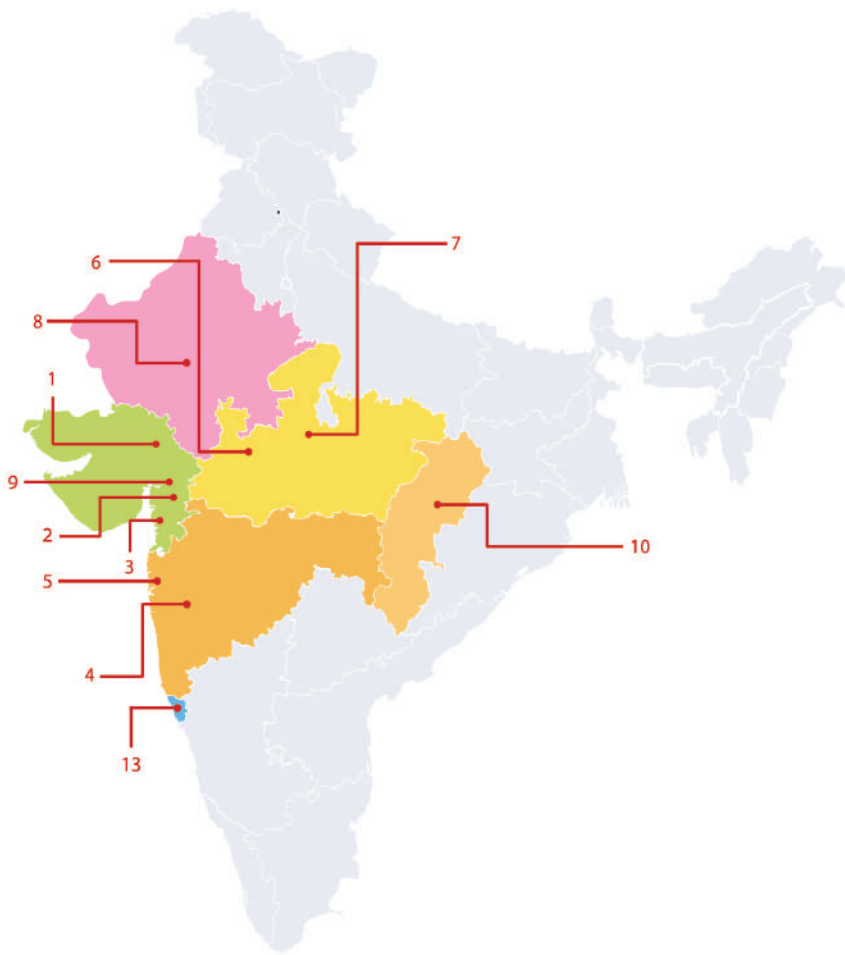

- 📍 **AHMEDABAD**
ie.csd@innerengineering.co.in
- 📍 **BARODA**
ie.contacts@innereng.com
- 📍 **SURAT**
ie.tejas@innerengineering.co.in
- 📍 **PUNE**
ie.pune@innerengineering.co.in
- 📍 **MUMBAI**
ie.mumbai@innereng.com
- 📍 **INDORE**
ie.mp@innerengineering.co.in
- 📍 **BHOPAL**
ie.bhopal@innereng.com
- 📍 **RAJASTHAN**
ie.rajasthan@innereng.com
- 📍 **ANAND**
ie.anand@innereng.com
- 📍 **CHHATTISGARH**
ie.chattisgarh@innereng.com
- 📍 **RETAIL SALES**
ie.retailsales@innerengineering.co.in
- 📍 **KUTCH**
ie.rajkot@innereng.com
- 📍 **GOA**
ie.goa@innereng.com

innerengineering.co.in



INNER ENGINEERING PRODUCTS & SYSTEMS PVT LTD

Registered Office (Ahmedabad)

📍 Ground Floor, Showroom No. 3, Brooklyn Tower, Next to YMCA Club, S.G Highway, Ahmedabad - 380015, Gujarat, India.

Branch Office (Pune)

📍 Office No 501, Fifth Floor, Archway, Plot No 5, Sopan Baug Society, Survey No 2/1, Balewadi, Pune- 421045, Maharashtra, India.

Branch Office (Vadodara)

📍 713/A, Atlantis Heights, Opp. Swagat Petrol Pump, Nr. Genda Circle, Vadodara - 390021, Gujarat, India.

📞 1800 572 7963

✉️ ie.inquiry@innerengineering.co.in

"Copyright © 2018-2022 INNER ENGINEERING. All Rights Reserved. All products denoted with™ (TM) ; (R) or © are registered intellectual property of Inner Engineering or its affiliates."